

Troubleshooting

If you have problems during the installation, please refer to the following online FAQs.

T1. Can't find the hardware version of the adapter:

<https://www.tp-link.com/faq-46.html>

T2. Can't find or connect to the wireless networks:

<https://www.tp-link.com/faq-2253.html>

T3. Can't install the driver:

<https://www.tp-link.com/faq-2252.html>

T4. How to fix Windows 7 Security issue:

<https://www.tp-link.com/faq-2760.html>

Safety Information

- Do not attempt to disassemble, repair, or modify the device.
- Do not use the device where wireless devices are not allowed.
- Keep the device away from water, fire, humidity or hot environments.
- This USB Adapter can only be powered by computers that comply with PS2 (IEC/EN 62368-1) or Limited Power Source (LPS) (IEC/EN 60950-1).



Wireless USB Adapter

Support

For technical support, replacement services, user guides, and other information, please visit <https://www.tp-link.com/support>, or simply scan the QR code.



1 Connect to a Computer

Option 1: Directly

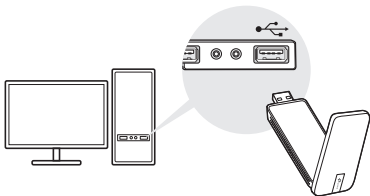

Option 2: Via the USB Extension Cable

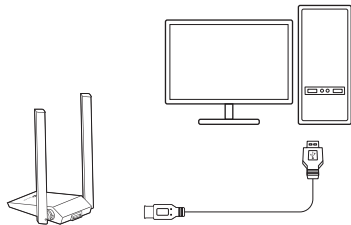

2 Install Driver

a. Insert the CD and run the **Autorun.exe**.

Note:

You can also download the driver or check the new release at <https://www.tp-link.com/download-center>

b. Select **your adapter** and follow the instructions to complete the installation.

Notes:

- If you can't install the driver successfully, disable the antivirus software and firewall, then try again.
- In Windows 7, if a Windows Security message pops up, refer to **Troubleshooting > T4**.
- If an unknown publisher message pops up, select **Yes** to continue.
- If Windows User Account Control requires admin credentials, type user name and password of your Windows administrator account.

3 Join a Wireless Network

a. Click the network icon  on the taskbar.

b. Select your Wi-Fi network, click **Connect** and enter the password when prompted.

